

# NBB-60-SG

## REFRIGERATED GLASS DOOR BACK BAR BEVERAGE COOLER

Ideal for restaurants, bars, and cafés

**NEW AIR**  
REFRIGERATION



### FEATURES

Stainless steel top & black stainless steel exterior

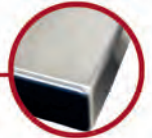

Adjustable epoxy-coated steel shelves

Self-closing doors with locks



Carel™ digital temperature controller, on/off switch, & interior thermometer



Adjustable feet



Interior LED lighting

Casters optional



# SPECIFICATIONS

Capacity (Cu. ft)	19
Capacity (Litres)	546
Exterior Unit Dimensions (in)	58.75" (w) x 29.25" (d) x 36.25" (h)
Interior Dimensions (in)	46.25" (w) x 22.5" (d) x 30.5" (h)
Packing Dimensions (in)	63" (w) x 31" (d) x 40" (h)
Net/Gross Weight (lbs)	254 /275
Material	Black coated steel/Stainless steel
Doors	2
Adjustable Shelves	4
Shelving Dimensions (in)	22.5" (w) x 21.5" (d)/per shelf
Casters	Optional
Shelf Capacity (lbs) (lbs)	90
Keg Capacity	2 x ½ Keg
Temperature (°C)	(0°C) - (5°C)
Refrigerant (CFC-Free)	R290
Amperage (A)	2.9
Voltage (V)	115V/60Hz
Plug Type	NEMA 5-15P

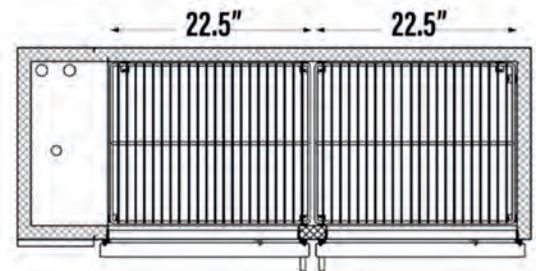
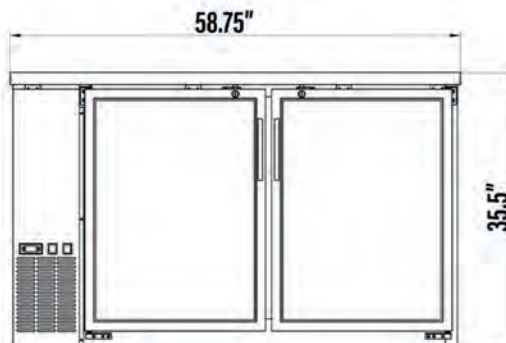
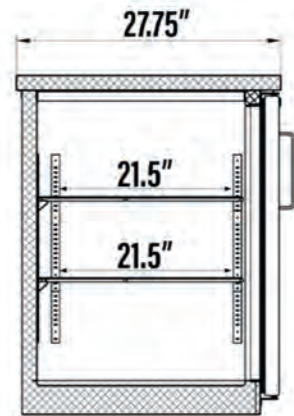

**NEW AIR**

\*Design and specifications can change without prior notice for product improvement

CUSTOMER SUPPORT



1-800-567-3620



NEWAIRREFRIGERATION.CA

