

NDC-36-CG

NEW AIR

CURVED GLASS REFRIGERATED DISPLAY CASE

Ideal for restaurants, cafés & bakeries



FEATURES

Air ducts on three (3) sides to remove condensation

Double tempered glass all around

Height & angle can be adjusted for each glass shelf

Bright LED lighting under each shelf

Rear sliding doors

Black-brushed stainless steel

Casters

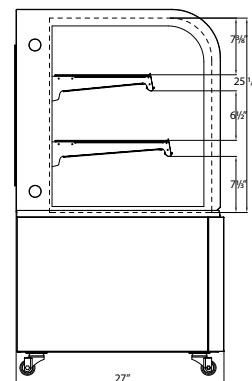

SPECIFICATIONS



Capacity (Cu. ft)	9.53
Capacity (Liters)	270
Exterior Dimensions (in)	37" x 27" x 47 3/4"
Interior Dimensions (in)	34" x 23" x 25 1/2"
Nbr of shelves	Two (2)
Temp. Range	2 TO 12°C
Refrigerant (CFC-Free)	R290
Amperage (A)	4.5A
Voltage (V)	120V/60Hz
Plug Type	NEMA 5-15P

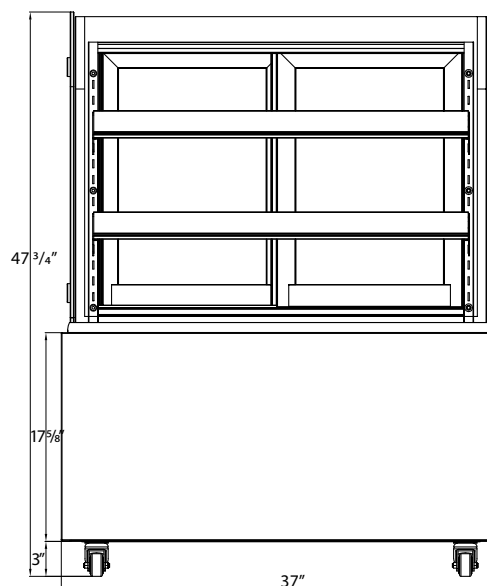

NEW AIR

*Design and specifications may change without prior notice for product improvement

CUSTOMER SUPPORT



1-800-567-3620



NEWAIRREFRIGERATION.CA



2025