

NCGD-46-S COUNTERTOP GELATO DISPLAY

Ideal for ice cream shops, restaurants and cafés



Features

- 6 x 1/3 gastronorm pans included
- Double-tempered glass with heater to prevent fogging
- Ventilated cooling system & automatic defrost
- Sliding doors at the back
- Digital temperature controller with LED display
- Brilliant cool-toned LED at top of unit
- 4 adjustable feet
- High-performance condenser with automatic water evaporation



Specifications

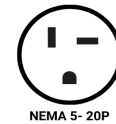

Capacity (Cu. ft)	3.17
Capacity (Liters)	15 L (6 x 1/3 gastronorm pans)
Exterior Dimensions (in)	46" x 33" x 24.5"
Package Dimensions (in)	49" x 36" x 31"
Shelf	6 pans
Door(s)	Sliding at the back
Temperature Range (°C)	-22°C TO -12°C
Ambient Temperature	≤ 30°C
Ambient Humidity	≤ 55%
Refrigerant (CFC-Free)	R290
Voltage (V)	110 - 120 V / 60Hz
Plug Type	NEMA 5-20P
Amperage	15A
Net Weight (kg/lb)	93kg / 205lb
Power	1700 W

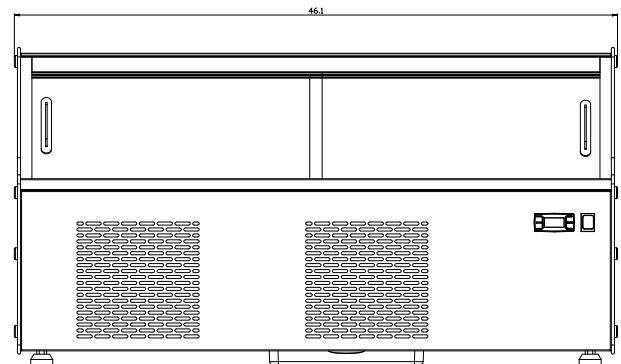
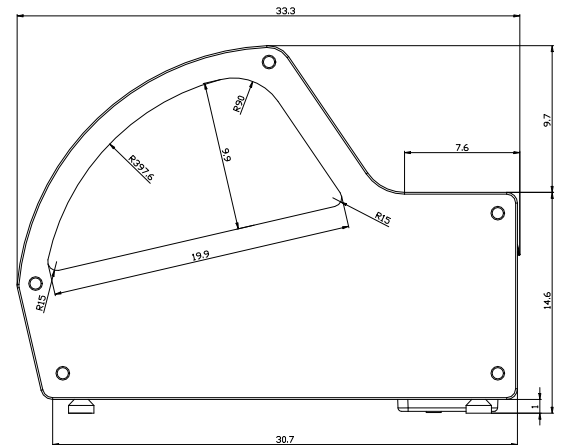

*Design and specifications may change without prior notice for product improvement

customer support



1-800-567-3620



Newairrefrigeration.ca

